

# AMALEA, AMAKRISTINA, AMAVIOLA, AMASTELLA

## Technical Data

**Year Built:**  
 AmaLea 2018  
 AmaKristina 2017  
 AmaStella 2016  
 AmaViola 2016  
**Length:** 443 ft.  
**Width:** 38 ft.  
**Crew:** 51  
**Staterooms:** 78  
**Passengers:** 156  
**Registry:** Switzerland

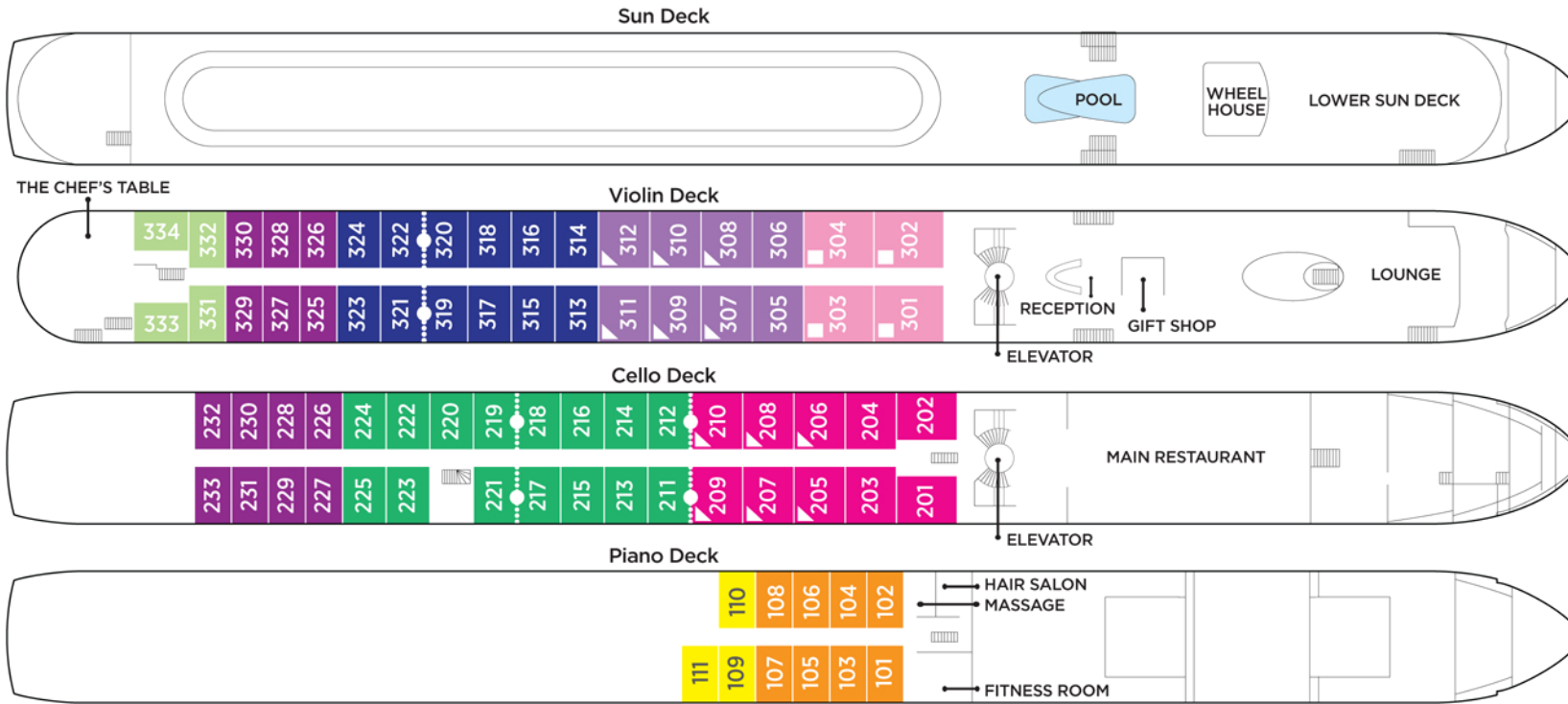

Elevator on AmaLea and AmaKristina reaches Main Restaurant, Lobby/Main Lounge and staterooms on Violin, Cello and Piano Deck.  
 Elevator on AmaViola and AmaStella reaches Main Restaurant, Lobby/Main Lounge and staterooms on Violin and Cello Deck.

Suite	Violin Deck/French & Outside Balcony - 350 sq. ft.
Cat. AA	Violin Deck/French & Outside Balcony - 235 sq. ft.
Cat. AB	Cello Deck/French & Outside Balcony - 235 sq. ft.
Cat. BA	Violin Deck/French & Outside Balcony - 210 sq. ft.
Cat. BB	Cello Deck/French & Outside Balcony - 210 sq. ft.
Cat. CA	Violin & Cello Deck/French Balcony - 170 sq. ft.
Cat. CB	Violin Deck/French Balcony - 155 sq. ft.
Cat. D	Piano Deck/Fixed Windows - 160 sq. ft.
Cat. E	Piano Deck/Fixed Windows - 160 sq. ft.

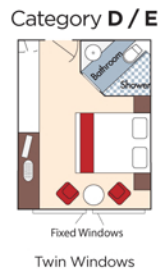
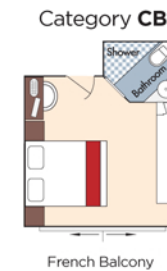
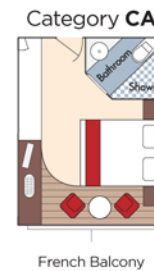
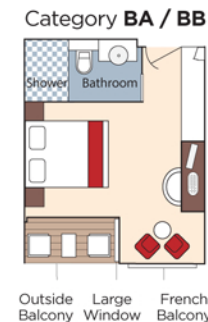
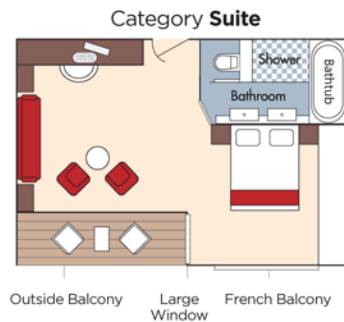

- ..... Staterooms can become connecting by request.
- ▲ Up to triple occupancy.
- Up to quadruple occupancy.

Note: Stateroom layouts are not to scale.  
 Staterooms 201 & 202 are slightly modified

